

37. IZVEDBA TESNENJA TUŠ KADICE V NIVOJU TLAKA

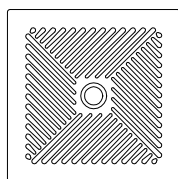
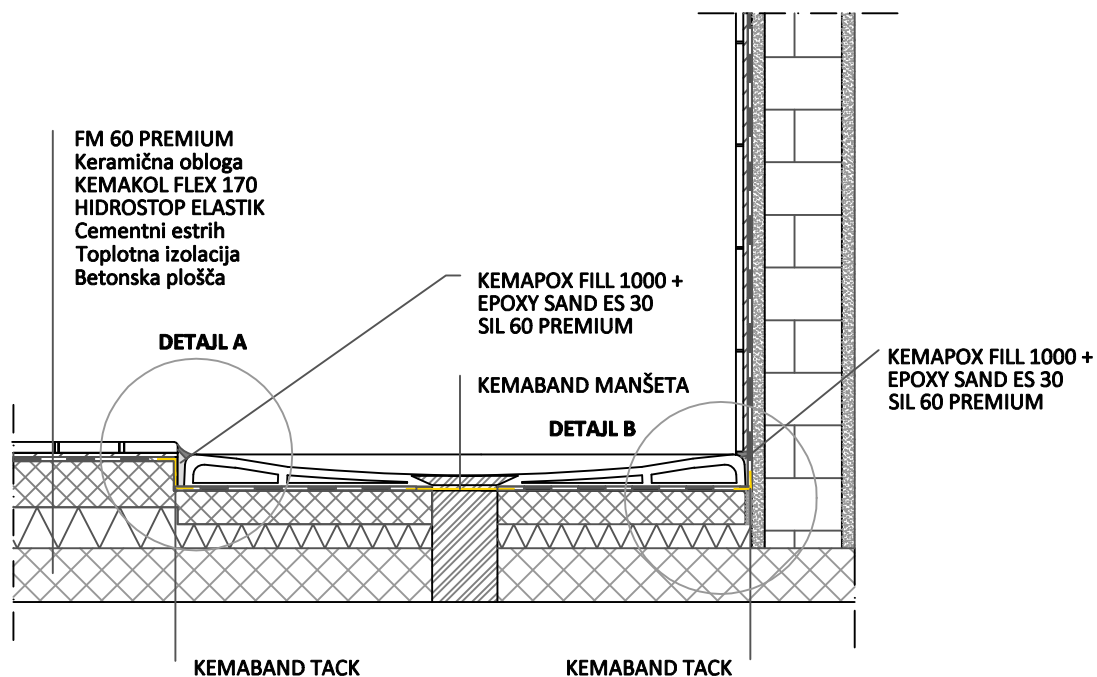

OPOMBA: Tuš kadica mora biti postavljena na stabilno podlago!

TEHNIČNI LISTI:

- KEMAKOL FLEX 170
- FM 60 PREMIUM CLASSIC
- HIDROSTOP ELASTIK
- KEMABAND MANŠETA
- KEMABAND TACK
- SIL 60 PREMIUM
- KEMAPOX FILL 1000
- EPOXY SAND ES 30

37. IZVEDBA TESNENJA TUŠ KADICE V NIVOJU TLAKA DETAJL A IN DETAJL B

DETAJL A

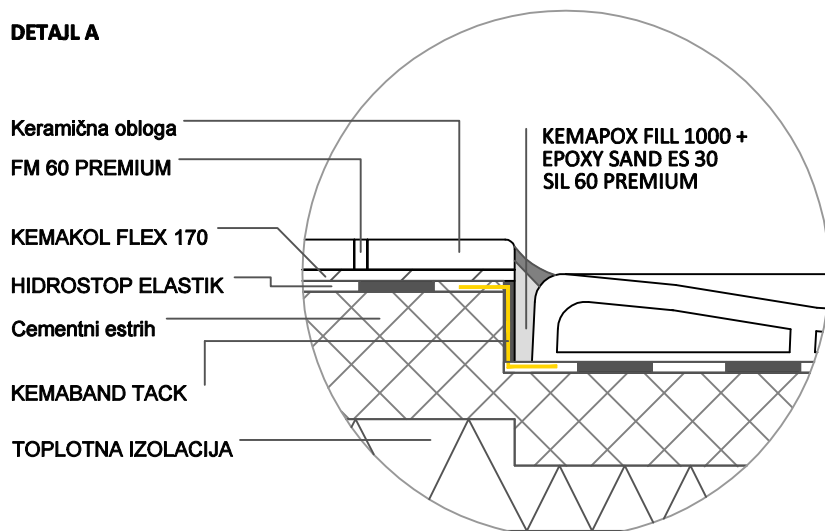

DETAJL B

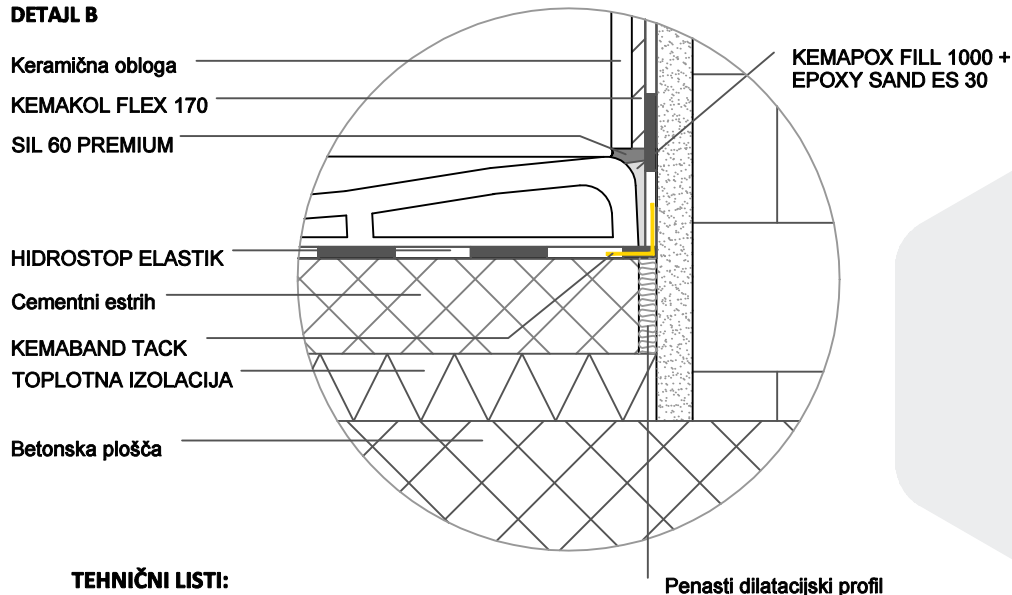

TEHNIČNI LISTI:

- KEMAKOL FLEX 170
- FM 60 PREMIUM CLASSIC
- LINEA 810 SL
- KEMAGRUND A